



Temporary Poker Facility

June 11, 2014



Speakers

- **Terry McKenna, Executive Vice President, Keating Consulting**
- **Wendy Hamilton, General Manager, SugarHouse Casino**
- **Rosemarie Cook, Vice President of Gaming, SugarHouse Casino**

Terry McKenna

Executive Vice President

Keating Consulting

Existing Casino

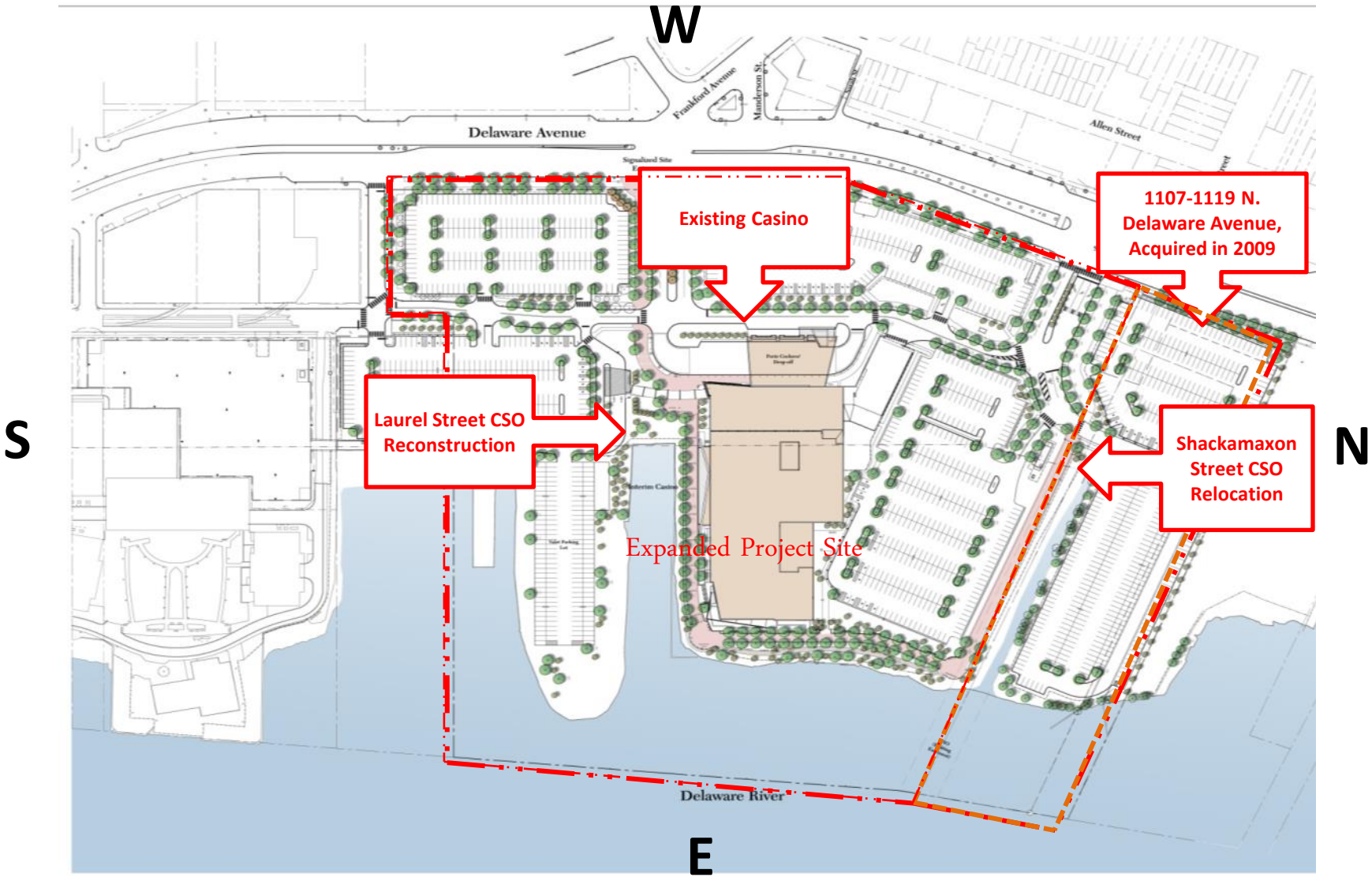

Phase 1A – Shackamaxon CSO



Looking northwest at the head of the Shackamaxon Street Drainage Channel and the existing brick sewer outfall



Between the casino site and Pier 42/43, looking southeast

Existing Casino

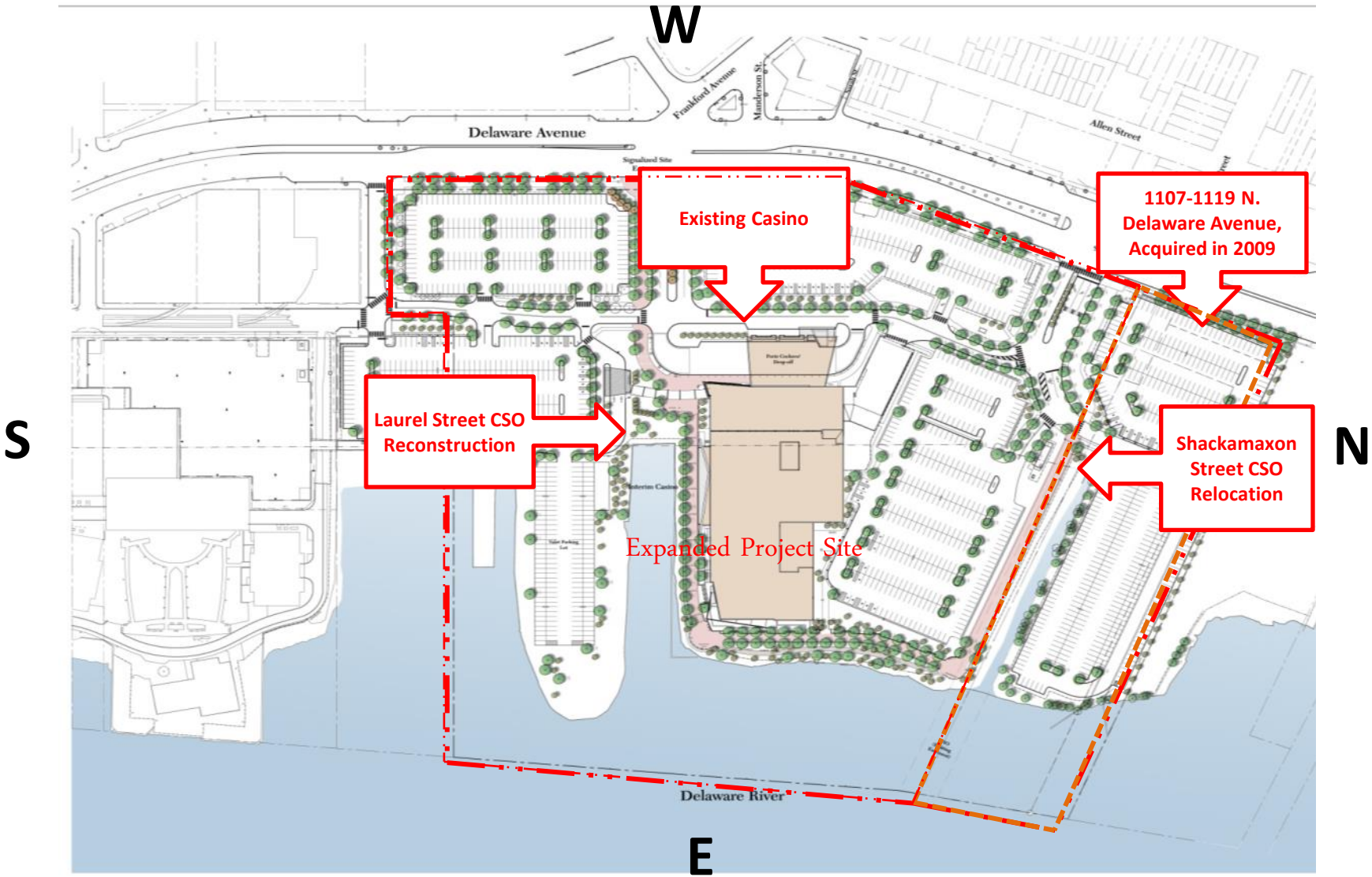

Phase 1A – Shackamaxon CSO



Looking northwest at the head of the Shackamaxon Street Drainage Channel and the existing brick sewer outfall



Between the casino site and Pier 42/43, looking southeast

Phase 1A – Site Plan

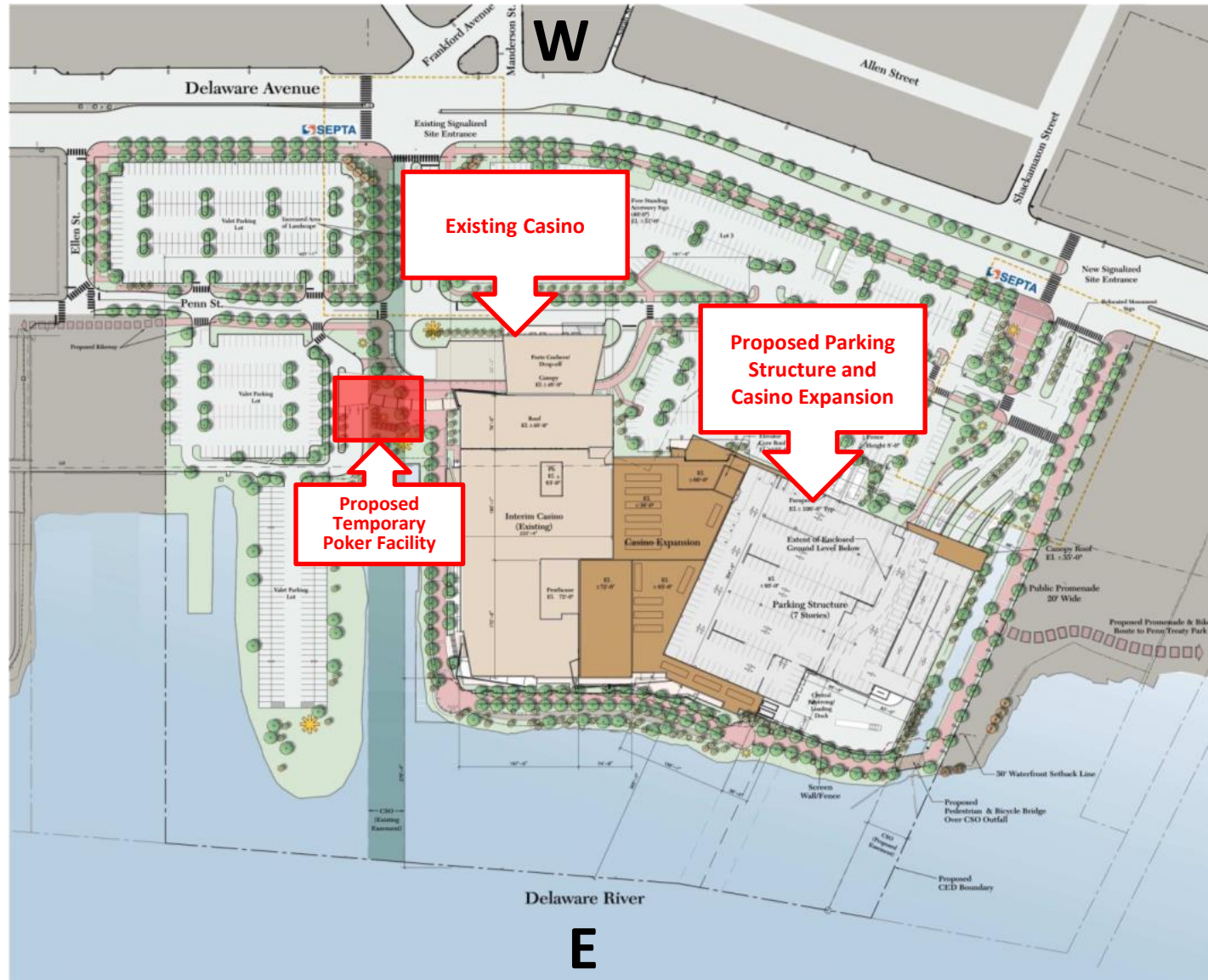

S

W

N

E

Temporary Poker Facility

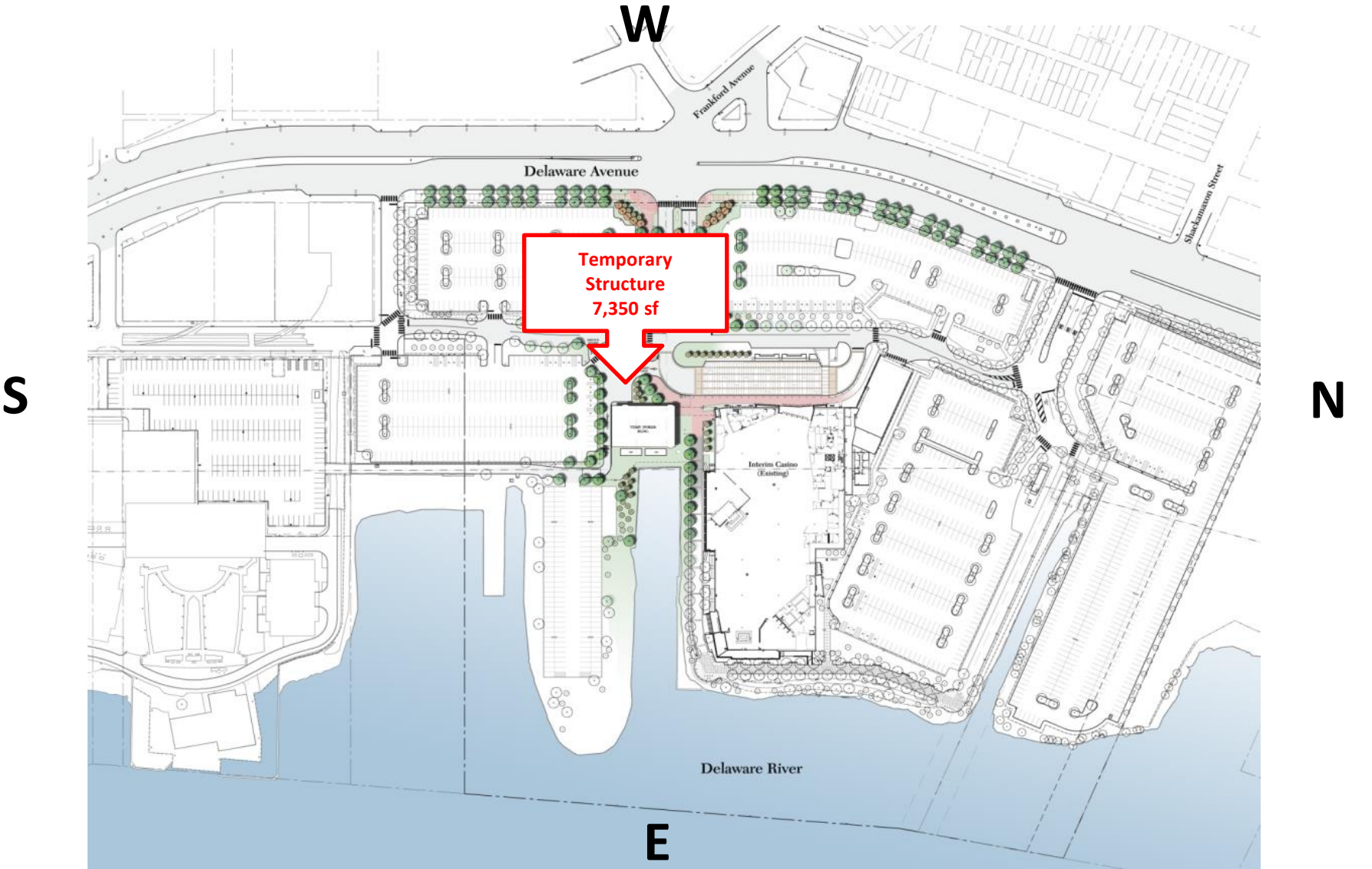

Laurel Street Work



Site Plan – Temporary Poker Facility

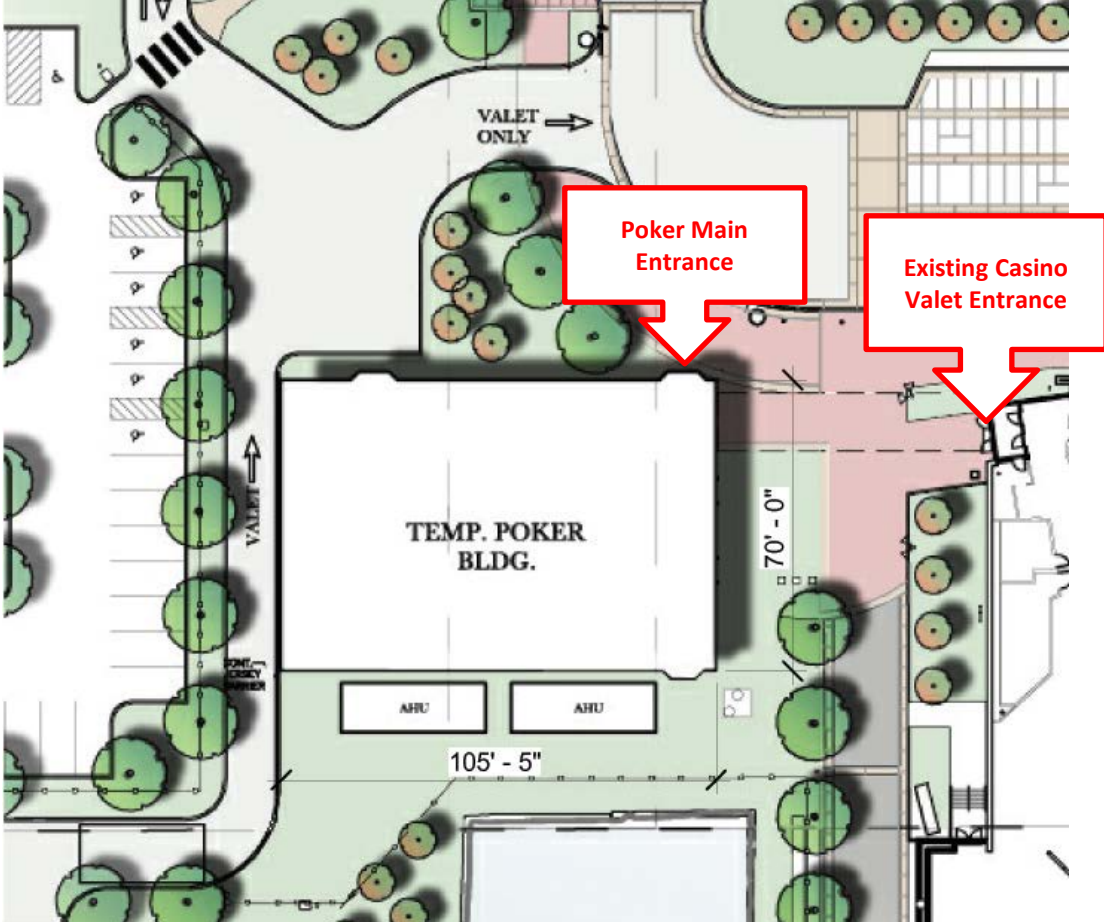

Elevation View from Delaware Avenue



Existing Casino

**Proposed Temporary
Poker Facility**

View from Delaware Avenue



Floor Plan – Temporary Poker Facility

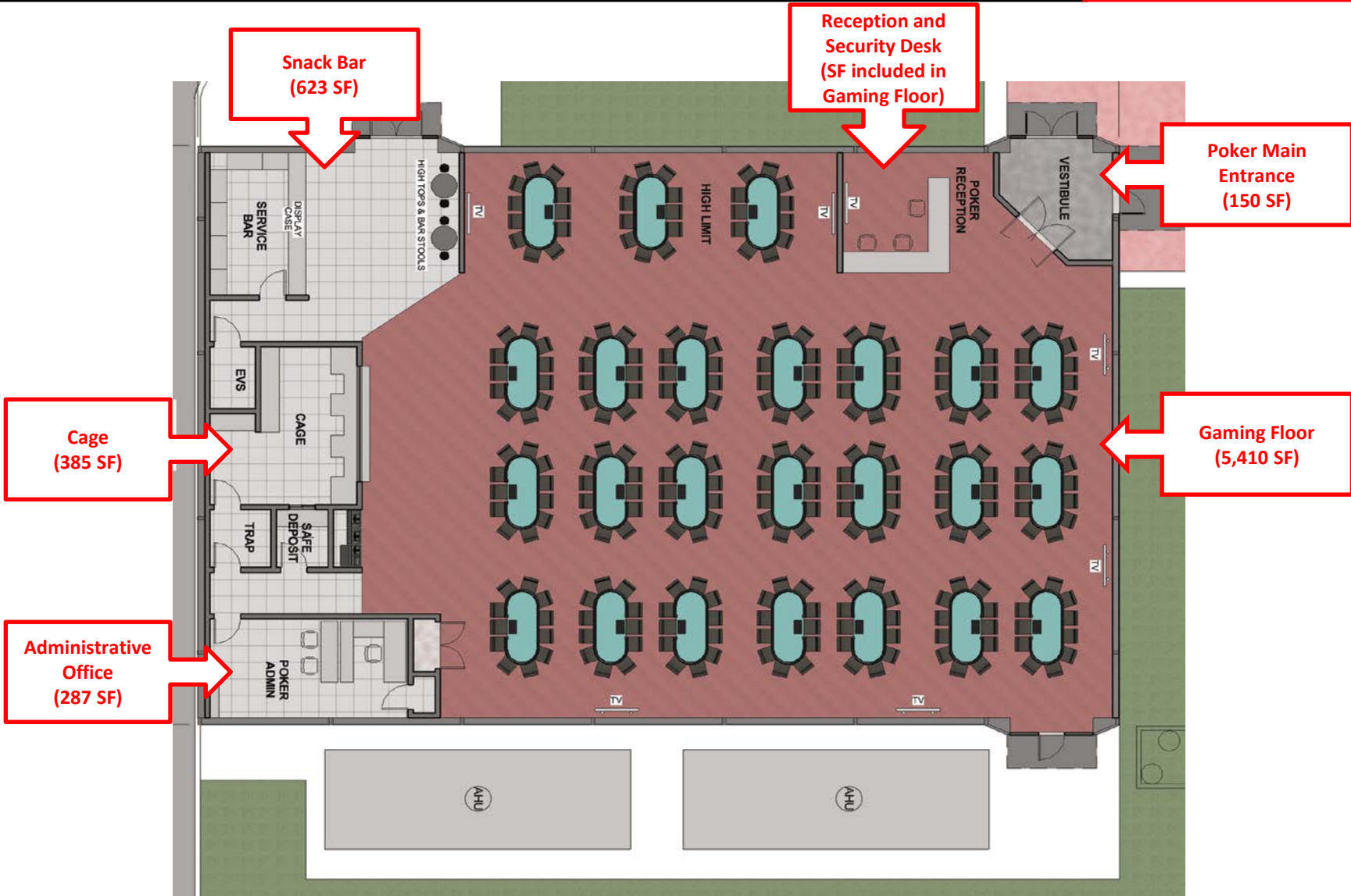

Project Schedule – Temporary Poker Facility



KEATING CONSULTING

PRELIMINARY PROJECT SCHEDULE
SUGARHOUSE CASINO - TEMPORARY STRUCTURE
June 2, 2014, Rev. 3.0

LINE	DESCRIPTION	2014												2015												2016			
		JAN	FEB	MAR	APR	MAY	JUNE	JULY	AUG	SEPT	OCT	NOV	DEC	JAN	FEB	MAR	APR	MAY	JUNE	JULY	AUG	SEPT	OCT	NOV	DEC	JAN	FEB	MAR	
		1	2	3	4	5	6	7	8	9	10	11	12	13	14	15	16	17	18	19	20	21	22	23	24	25	26	27	
1	APPROVALS																												
2	PGCB APPROVAL PROCESS																												
3	ZONING PERMIT - CITY OF PHILADELPHIA																												
4	BUILDING PERMIT - CITY OF PHILADELPHIA																												
5																													
6	CONSTRUCTION (DESIGN/BUILD)																												
7	SITWORK/UNDERGROUND SERVICES																												
8	CONCRETE PAD																												
9	SPRUNG STRUCTURE ERECTION																												
10	INTERIOR FIT-OUT																												
11	TEMPORARY CERTIFICATE OF OCCUPANCY																												
12	OWNER MOVE-IN																												
13	CERTIFICATE OF OCCUPANCY & GRAND OPENING																												
14																													
15	OPERATIONS																												
16	OPERATION OF STRUCTURE																												
17	SHUTDOWN OF STRUCTURE																												
18	DISMANTLEMENT OF STRUCTURE																												

Phase 1A Permits/Approvals

- Updates on permitting and approvals have been provided to PGCB staff
- City Planning Commission Approval, November 15, 2011
- City Submerged Lands License Approval, January 31, 2012
- City Ordinances amending Zoning Code, December 1, 2011 and May 2, 2013
- PennDOT on Highway Occupancy Permit (In Progress; expected mid-July 2014)
- PADEP Earth Disturbance Permits (Amendment obtained March 11, 2014; Further amendment in progress, expected early August 2014)
- PADEP Chapter 105/US Army Corps 10/404 Permits (Issued March 17, 2014 and June 5, 2014, respectively)
- Working with the City of Philadelphia to secure all other necessary permits to commence construction (All approvals are By-Right)
- +/- 15 month construction schedule from start of the Shackamaxon CSO Relocation in June 2014 (Fall 2015 Grand Opening); Garage and building foundations scheduled to begin in August 2014

Project Schedule – Phase 1A



PRELIMINARY PROJECT SCHEDULE
SUGARHOUSE CASINO EXPANSION
June 6, 2014 - Rev. 5.0

LINE	DESCRIPTION	2013												2014												2015												2016		
		MAR	APR	MAY	JUNE	JULY	AUG	SEPT	OCT	NOV	DEC	JAN	FEB	MAR	APR	MAY	JUNE	JULY	AUG	SEPT	OCT	NOV	DEC	JAN	FEB	MAR	APR	MAY	JUNE	JULY	AUG	SEPT	OCT	NOV	DEC	JAN	FEB	MAR		
				1	2	3	4	5	6	7	8	9	10	11	12	13	14	15	16	17	18	19	20	21	22	23	24	25	26	27	28	29	30	31	32	33	34			
1	LAUREL STREET CSO																																							
2	DESIGN																																							
3	PERMITTING																																							
4	BIDDING/AWARD																																							
5	CONSTRUCTION - PHASE 1																																							
	CONSTRUCTION - PHASE 2																																							
6																																								
7	SHACKAMAXSON STREET CSO																																							
8	CONCEPTUAL DESIGN																																							
9	PERMITTING																																							
10	DESIGN																																							
11	BIDDING/AWARD																																							
12	CONSTRUCTION																																							
13																																								
14	OFF-SITE ROADWAY																																							
15	DESIGN																																							
16	PERMITTING																																							
17	BIDDING/AWARD																																							
18	CONSTRUCTION																																							
19																																								
20	PARKING LOT RECONFIGURATION																																							
21	DESIGN																																							
22	PERMITTING																																							
23	BIDDING/AWARD																																							
24	CONSTRUCTION																																							
25																																								
26	CASINO EXPANSION																																							
27	SCHEMATIC DESIGN																																							
28	DESIGN DEVELOPMENT																																							
29	CONSTRUCTION DOCS.																																							
30	PROCUREMENT																																							
31	CONSTRUCTION																																							
32	TEMPORARY CO																																							
33	OWNER INSTALL																																							
34	GRAND OPENING																																							
35	BOH RENOVATION WORK																																							
36	PROJECT CLOSEOUT																																							
37	PERMANENT CO																																							

Phase 1A – Project Budget

Project Budget – \$164M

- Initial budget of \$155M increased to \$164M
- \$3.6M expended to date on planning, development, professional fees, and related property improvements
- Excludes costs associated with the Laurel Street CSO Reconstruction and the Temporary Poker Facility

Wendy Hamilton

General Manager
SugarHouse Casino

Rosemarie Cook

Vice President, Gaming
SugarHouse Casino

Temporary Poker Facility

Temporary Facility

- Demand for Poker in Philadelphia
- 24/7 operation, including food and beverage offerings (alcohol service pursuant to licensed hours)
- Removed within 24 months

Capital Investment of \$2.9M

Revenue to the City and Commonwealth

- Revenue potential for 13 months of operation is expected to exceed \$11M
- Additional gaming tax to the City and Commonwealth based on revenue potential for 13 months of operation is estimated at \$1.8M, including approximately \$340K to the City in Local Share Assessment, Business Privilege Tax, and Settlement Taxes

Temporary Poker Facility

Employment

- 100 new permanent jobs related to Temporary Poker Facility, including Gaming, Security, Surveillance, Cage, and Food & Beverage

Dealers/Dealer School

- 80 Poker Dealer positions, filled with a mix of experienced and newly trained dealers
- Free SugarHouse Poker School will be open to current employees and candidates from the immediate community

Temporary Poker Facility

Current Security Plan*

- Security Officers in the Temporary Poker Facility at all times; Security Officer stationed at the entrance and Security Officer to rove within the facility
- Full compliment of fire sprinklers and safety alarms tied directly to main casino system

Current Surveillance Plan*

- New surveillance cameras; all monitored by Surveillance and recorded per PGCB regulations
- Surveillance and Security will be alerted if cage or safety alarms are activated (identical system to all other casino areas)

* Pending PGCB approval

Temporary Poker Facility

Internal Controls*

- Pending PGCB approval of Temporary Poker Facility, we are prepared to submit all required documents to PGCB Gaming Operations and Compliance for approval

* *Pending PGCB approval*

Conclusion