



NEMACOLIN
WOODLANDS RESORT



NEMACOLIN

Table Games Public Input Hearing

February 7, 2013



NEMACOLIN
WOODLANDS RESORT



Chris Plummer

General Manager

Nemacolin Woodlands Resort



NEMACOLIN
WOODLANDS RESORT



Agenda

Highlights of Woodlands Fayette, LLC Application

Chris Plummer

Construction Update and Financial Suitability

Arnold Block

Management Team, Table Games Overview, Dealer School, Economic Impact, Recruiting

Rich Laudon



NEMACOLIN
WOODLANDS RESORT



Resort Facts

- ▶ Hosts 350,000 guests annually
- ▶ Guests from 48 states and 6 countries
- ▶ Nearly 2,000 acres in Southwestern Pennsylvania
- ▶ Employs approx. 900 Pennsylvanians
- ▶ Annual payroll \$23 million

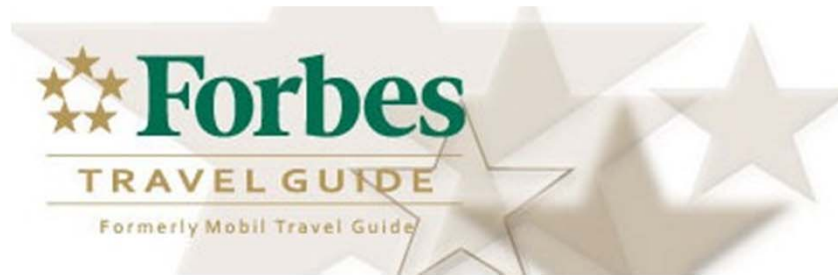

NEMACOLIN
WOODLANDS RESORT

ONE OF AMERICA'S PREMIER RESORTS



NEMACOLIN
WOODLANDS RESORT



Arnold Block

Chief Operating Officer
Isle of Capri Casinos, Inc.



NEMACOLIN
WOODLANDS RESORT



Isle of Capri Casinos, Inc. Facts

- ▶ Owns and operates 15 casinos in 6 states
- ▶ Publicly traded on NASDAQ - ISLE
- ▶ Featuring approx. 14,000 slot machines and over 330 table games
- ▶ Annual payroll \$253 million



NEMACOLIN WOODLANDS RESORT





NEMACOLIN
WOODLANDS RESORT



NEMACOLIN

- ▶ Approx. \$60 million investment
- ▶ Anticipated opening Summer 2013
- ▶ 600 slot machines
- ▶ 28 table games
- ▶ 2 restaurants
- ▶ Otis & Henry's
- ▶ Lone Wolf



NEMACOLIN WOODLANDS RESORT



NEMACOLIN WOODLANDS RESORT

- Symbol Legend
- Electrical Room
 - IDF Room
 - Mechanical Room
 - Mens Restroom
 - Trash
 - Unisex Restroom
 - Womens Restroom

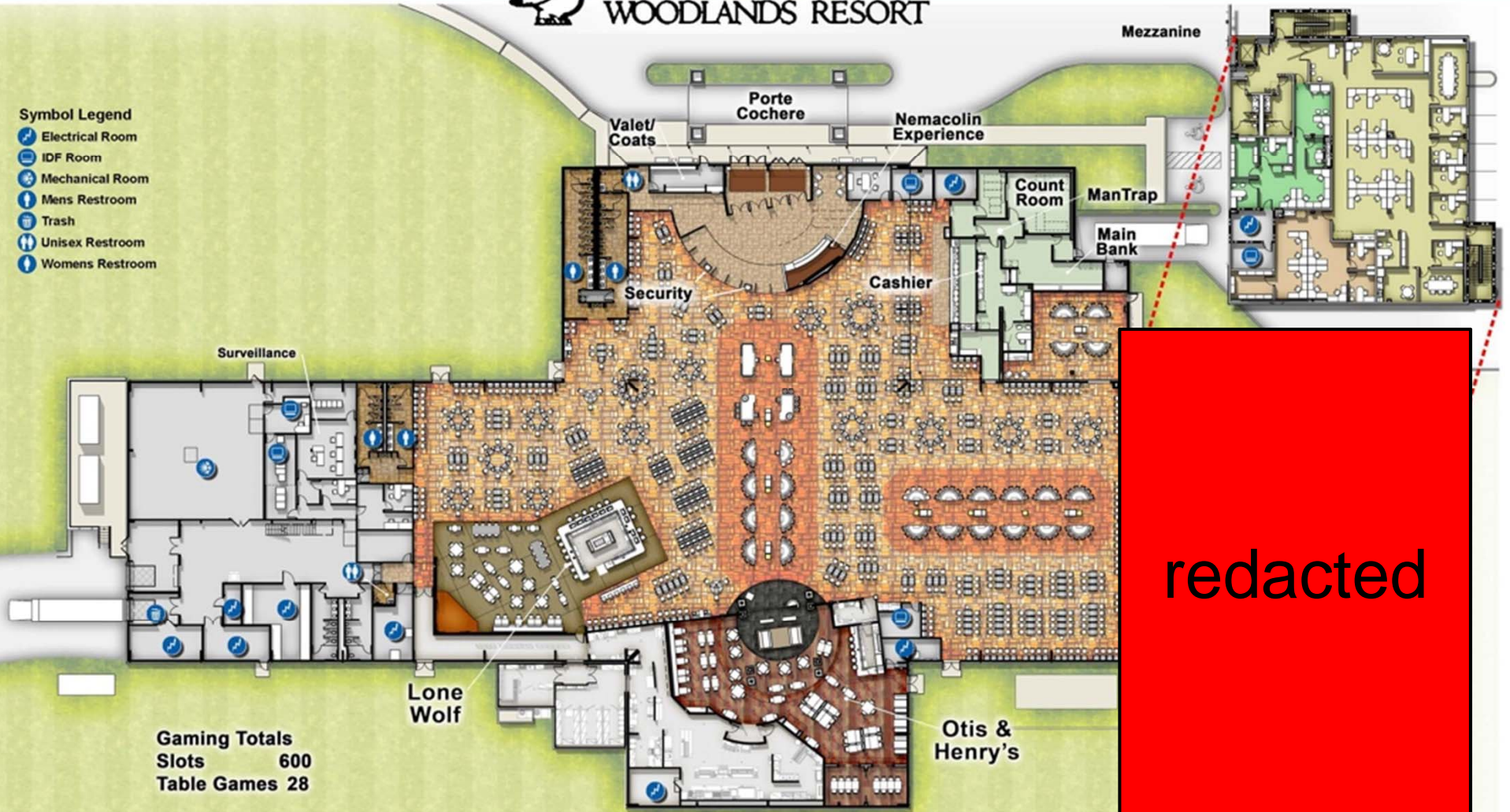

Gaming Totals
 Slots 600
 Table Games 28

redacted



NEMACOLIN
WOODLANDS RESORT



Construction Update

- Existing building
- Construction began October 2012, anticipated opening Summer 2013
- Keating Building Company, general contractor



NEMACOLIN
WOODLANDS RESORT



Financial Suitability

- › No additional financing is needed to accommodate table games
- › IOC-PA will fund \$7.5 million table games authorization fee and all capital expenditures required
- › Utilizing Isle's internally generated funds and/or existing revolving line of credit
- › Borrowing capacity as of Oct. 28, 2012: \$200 million.



NEMACOLIN
WOODLANDS RESORT



Vice President & General Manager

- › **Rich Laudon**, vice president & general manager
- › Diverse background in multiple gaming jurisdictions
- › Most recently served as vice president & general manager at Argosy Casino, Alton, Illinois
- › Previously held positions at Sky Ute Casino & Lodge, Casino Rama, Carnival Casino Hotels, Harrah's Casino New Orleans, Bobby Womack's Saloon and Gaming Parlor, Harrah's Lake Tahoe, Trump Plaza and Harrah's at Trump Plaza



NEMACOLIN
WOODLANDS RESORT



Management Team

- › Merryan Rutherford, director, operations
- › Terry Gwinn, director, finance
- › Michael Giunti, director, marketing
- › Danielle Grimley, director, HR
- › Amanda Loveland, compliance officer*
- › Christopher Schroder, surveillance manager
- › Mark Starrett, security manager*
- › James Haston, IT manager
- › Michael Prokop, casino manager



Table Games Offered

Craps with Fire Bet	2
Let It Ride	2
Mississippi Stud	2
Roulette	2
Three Card Poker	2
Blackjack	10
Blackjack with House	4
Four Card Poker	2
Ultimate Texas Hold'em	2
Total	28



NEMACOLIN
WOODLANDS RESORT



Economic Impact: Table Games

- ▶ Table games tax estimate: approximately \$1.4 million
- ▶ 14 % for 1st 2 years, 12% thereafter
- ▶ Local share - 2%



NEMACOLIN
WOODLANDS RESORT



Employment Impact

- ▶ Table games positions: approx. 130
- ▶ Total casino workforce: approx. 400
- ▶ Temporary construction jobs for entire facility: approx. 275



NEMACOLIN
WOODLANDS RESORT



Dealer School



- ▶ Free dealer school will be operated by IOC-PA
- ▶ Located in the former Gun Museum building next to the casino
- ▶ School to open February 11, 2013
- ▶ As students complete school, auditions will be held to determine which students will be hired





NEMACOLIN
WOODLANDS RESORT



Recruiting



- › Lady Luck Casino Nemascolin is committed to meeting the residency requirements of the Commonwealth and to create a diverse workforce
- › Tools to be utilized:
 - › Local Newspapers
 - › Isle of Capri website
 - › Casino Careers website and other online resources
 - › Local placement services and skill centers



NEMACOLIN
WOODLANDS RESORT



Workforce Development



- › Best employees run the best businesses
- › Focus on employee retention
- › Pay-for-Skills incentive pay & bonusing
- › Competitive wages & benefits package
- › Industry-leading service & training programs





NEMACOLIN
WOODLANDS RESORT



Responsible Gaming



- › Lady Luck Casino Nemacolin encourages its employees to always act responsibly, treat people with respect and look out for others, including coworkers as well as guests.
- › Every employee is trained regarding responsible gaming
- › We make certain that guests have easy access to responsible gaming information
- › We are a member of the Council on Compulsive Gambling of Pennsylvania



NEMACOLIN WOODLANDS RESORT

