

Revisions: Drawn By: Date: App'd. By: Date:

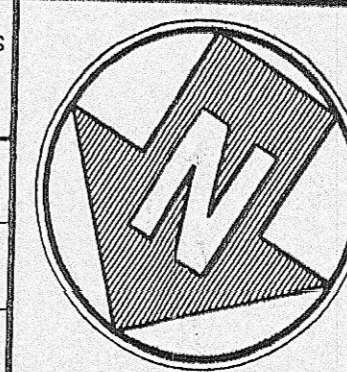

Designed By: DMF Date: 05/05  
Drawn By: JDF Date: 05/05  
Checked By: WAH Date: 05/05  
UNAUTHORIZED ALTERATION OR REVISION OF THIS DOCUMENT IS A VIOLATION OF SECTION 2208 STATE EDUCATION LAW

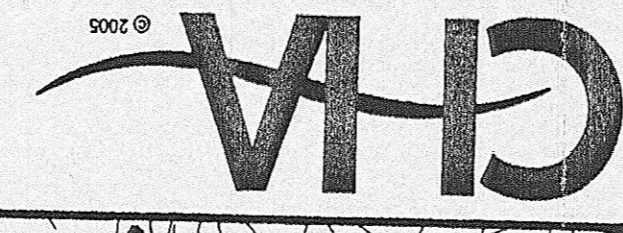

CLOUGH HARBOUR & ASSOCIATES LLP  
111 Wilshire Circle, PO Box 5288, Albany, NY 12205  
Tel: (518) 453-4500 - www.cloughharbour.com  
© 2005

POCONO CASINO  
POCONO, PENNSYLVANIA

BEDROCK ELEVATION PLAN

POCONO CASINO  
PHASE I

3

SCALE: 1" = 100'  
DATE: MAY, 2005  
SHEET 1 OF 1

NOTE:  
THE BEDROCK CONTOURS SHOWN ARE AN INTERPRETATION BETWEEN THE AVAILABLE BORINGS. THE BEDROCK ELEVATIONS BETWEEN THE AVAILABLE BORINGS MAY DIFFER FROM THOSE SHOWN ON THE PLAN.

LEGEND  
700- INTERPRETED BEDROCK CONTOUR

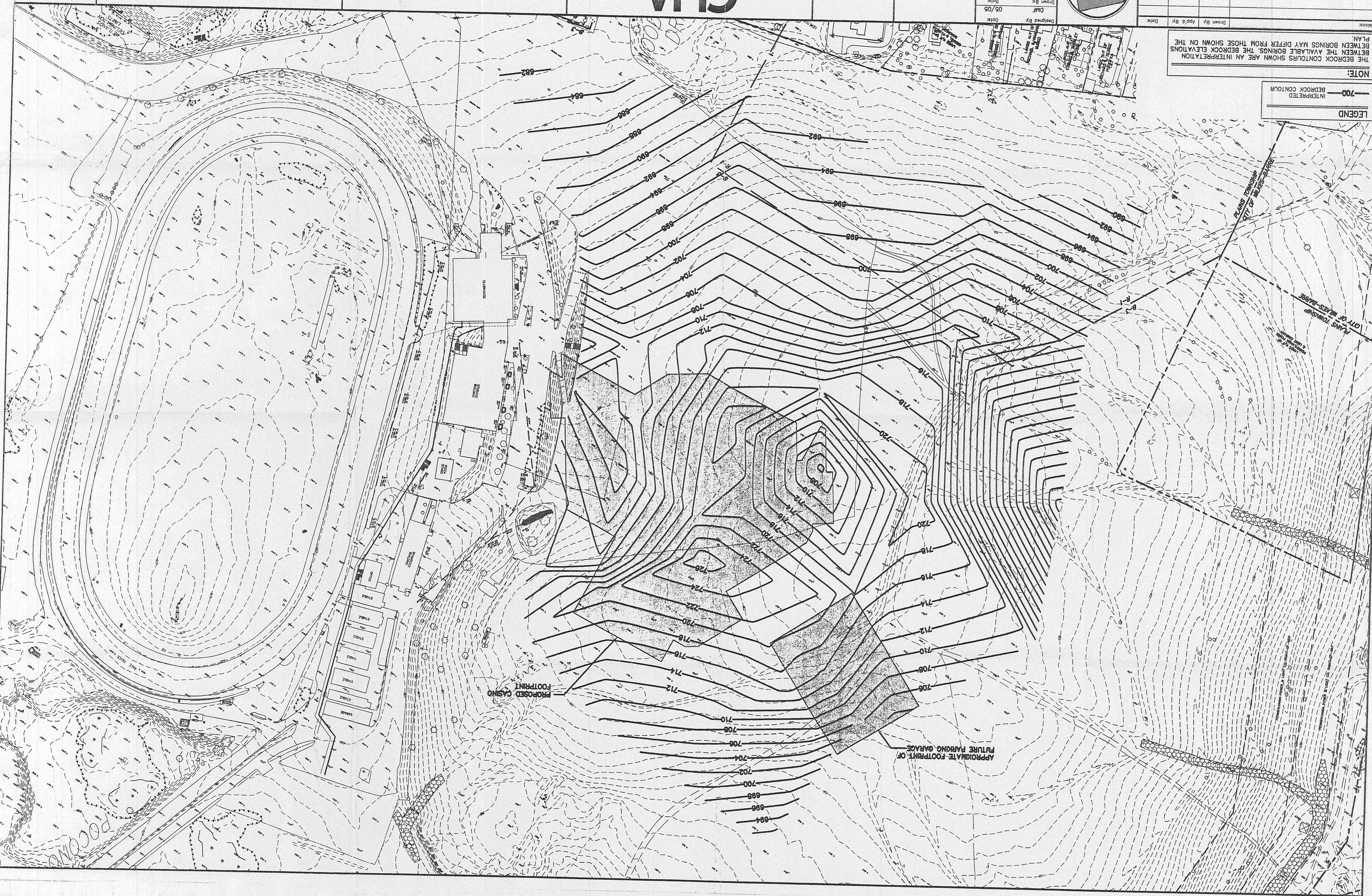

Revisions	Drawn By	App'd By	Date

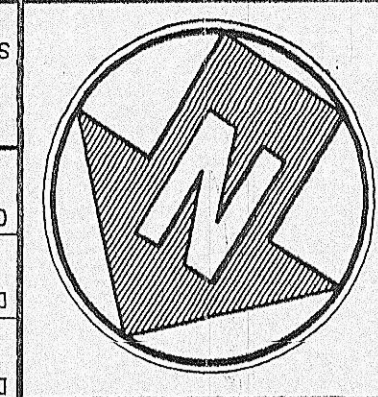

STATE EDUCATION LAW  
 SUBSECTION 2 OF THE NEW YORK  
 A VOUCHER OF SECTION 708  
 UNAUTHORIZED ALTERATION OR  
 ADDITION TO THIS DOCUMENT IS  
 PROHIBITED  
 Date: 05/05  
 Drawn By: DMF  
 Date: 05/05  
 Checked By: JDF  
 Date: 05/05  
 WAH  
 Date: 05/05

**CHA**  
 CLOUGH HARBOUR & ASSOCIATES LLP  
 111 Winans Circle, PO Box 6288, Albany, NY 12205  
 MAin: (518) 463-6500 • www.cloughharbour.com  
 CHA Project No. 13989

POCONO CASINO  
 POCONO, PENNSYLVANIA

POCONO CASINO  
 PHASE 1  
 BORING LOCATION PLAN

Drawing No. **2**  
 SHEET 1 OF 1

**LEGEND**

⊙ B-1 BORING LOCATION

